

# Conference Room Venus

A bright space designed in white base tones.

## Main Uses

Exhibitions, workshops, internal meetings and training, courses and seminars

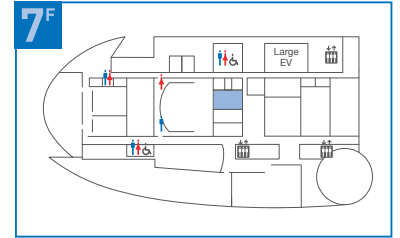

## Basic layout (Theater-style)



Floor plan

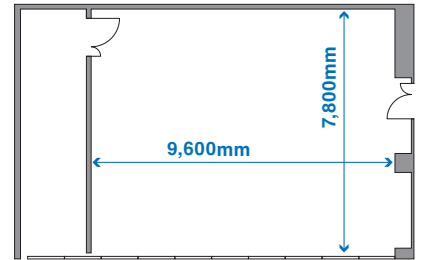

Basic layout plan

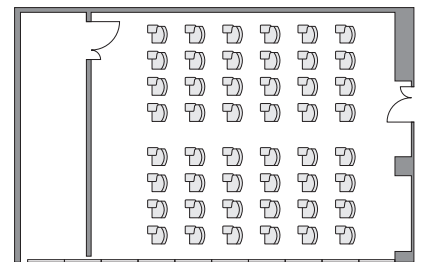

## Layout Examples

### Classroom style

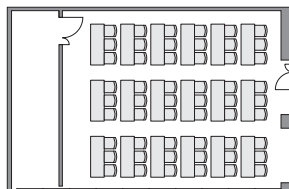

### Island style

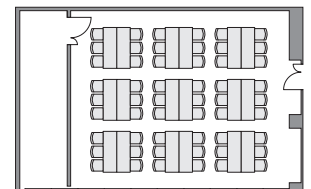

## Specifications

| Floor space      | Ceiling height                                 | Theatre-style        | Classroom style | Island style    |
|------------------|------------------------------------------------|----------------------|-----------------|-----------------|
| 80m <sup>2</sup> | 3m                                             | 48 seats             | 54 seats        | 54 seats        |
| Projector        | Projection on wall                             | Wireless microphones | Audio equipment | Roll-up curtain |
| ○                | (projection size) 120 inches aspect ratio 16:9 | 2                    | ○               | ○               |

\* The projection wall can be changed in the Venus room.

# Conference Room Mercury, Mars, Venus

Movable partition walls in conference rooms Mercury, Mars, and Venus can be put away, enabling the rooms to be used as a single large conference room of 195 m<sup>2</sup>.

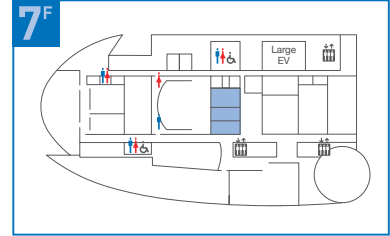

## Basic layouts (Hollow square and theater style)



Floor plan / Basic layout plan

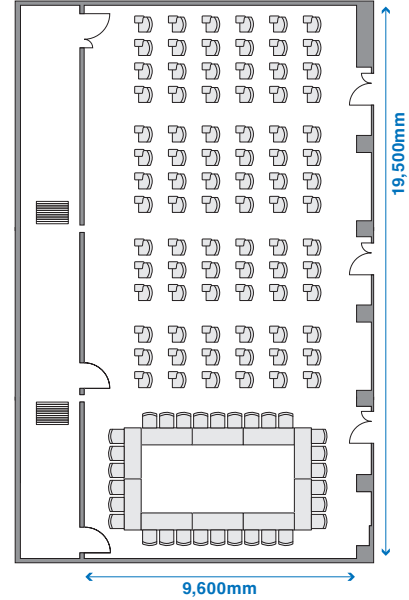

## Layout Examples

### Classroom style

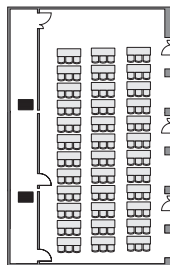

### Theatre-style

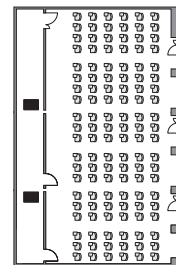

## Specifications

| Floor space       | Ceiling height                                                                              | Hollow square and theatre style | Classroom style | Theatre-style   |
|-------------------|---------------------------------------------------------------------------------------------|---------------------------------|-----------------|-----------------|
| 195m <sup>2</sup> | 3m                                                                                          | 114 seats                       | 108 seats       | 120 seats       |
| Projector         | <b>3-Sided Projection on wall</b><br>(each projection size) 120 inches<br>aspect ratio 16:9 | Wireless microphones            | Audio equipment | Roll-up curtain |
| 3                 |                                                                                             | 6                               | ○               | ○               |

\* The projection wall can be changed in the Venus room.

## Lobby(1)



Floor plan

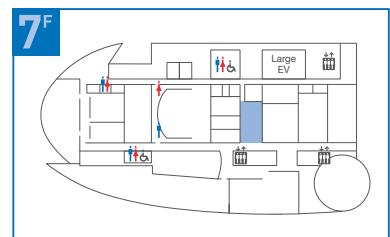
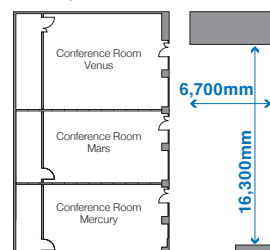

\* The lobby (1) can be used exclusively for a fee when the Mercury, Mars and Venus conference rooms are rented simultaneously.(See\*List of Facility Usage Fees\*, P24)