

Conference Room Venus

A bright space designed in white base tones.
Fully equipped with a projector that can project on the wall at 120 inches, this room is suitable for a wide range of uses including seminars, conferences, and presentations.

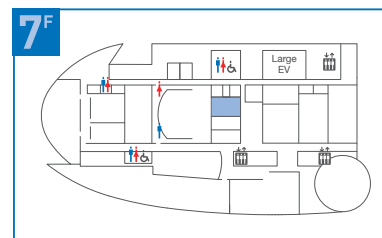

Basic layout (Theater-style)



Floor plan

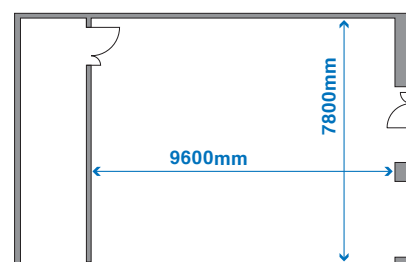

Basic layout plan

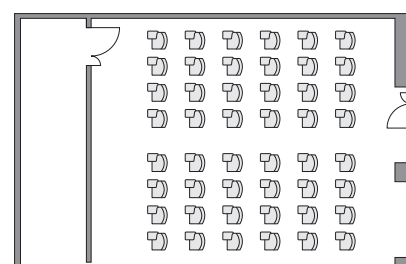

Layout Examples

Classroom style

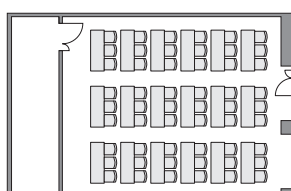

Island style

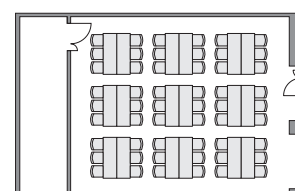

Specifications

| Floor space | Ceiling height | Theatre-style | Classroom style | Island style |
|------------------|---|--|-----------------|-----------------|
| 80m ² | 3m | 48 seats | 54 seats | 54 seats |
| Projector | Projection on wall | Wireless microphones | Audio equipment | Roll-up curtain |
| ○ | (projection size) 120 inches aspect ratio 16:9 | 2 handheld microphones and 1 pin microphone | ○ | ○ |

* The projection wall can be changed in the Venus room.

Conference Room

Mercury, Mars, Venus

Movable partition walls in conference rooms Mercury, Mars, and Venus can be put away, enabling the rooms to be used as a single large conference room of 195 m².

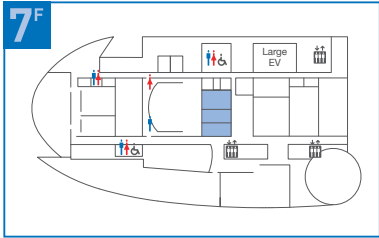

Basic layouts (Hollow square and theater style)



Floor plan / Basic layout plan

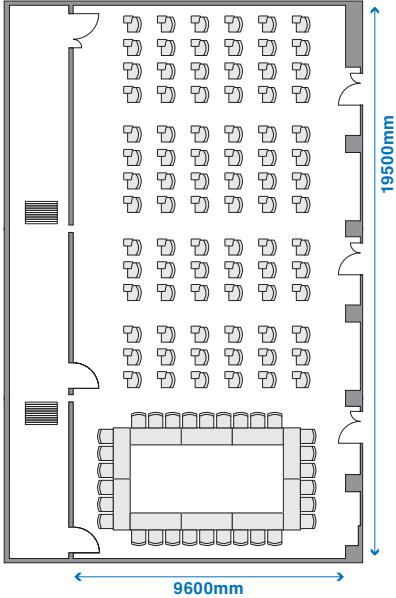

Layout Examples

Classroom style

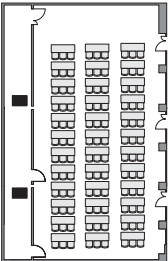

Theatre-style

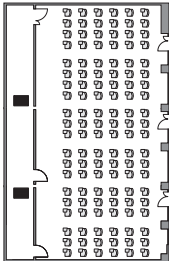

Specifications

| Floor space | Ceiling height | Hollow square and theatre style | Classroom style | Theatre-style |
|-------------------|---|--|-----------------|-----------------|
| 195m ² | 3m | 114 seats | 108 seats | 120 seats |
| Projector | 3-Sided Projection on wall | Wireless microphones | Audio equipment | Roll-up curtain |
| 3 | (each projection size) 120 inches aspect ratio 16:9 | 6 handheld microphones and 3 pin microphones | ○ | ○ |

* The projection wall can be changed in the Venus room.

Lobby(1)



Floor plan

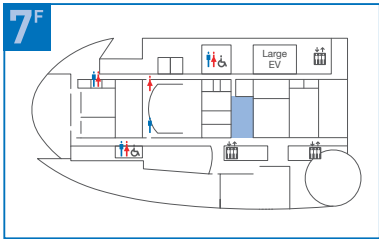
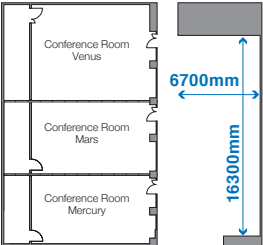

* The lobby (1) can be used exclusively for a fee when the Mercury, Mars and Venus conference rooms are rented simultaneously.(See"List of Facility Usage Fees", P24)

Floor Map

List of Rental Facilities

Rental Facilities

Outdoor layout / Floor plan

List of Facility Usage Fees

List of equipment

Terms and Conditions of Use

Flow of Procedures

Other Facilities and Services

Access / Map of Odaiba