

Conference Room Mercury

A bright space designed in white base tones.

Main Uses

Exhibitions, workshops, internal meetings and training, courses and seminars

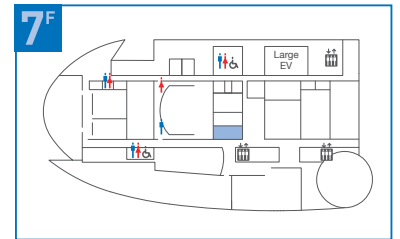

Basic layout (Hollow square style)



Floor plan

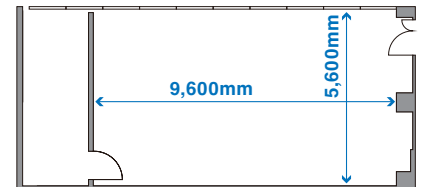

Basic layout plan

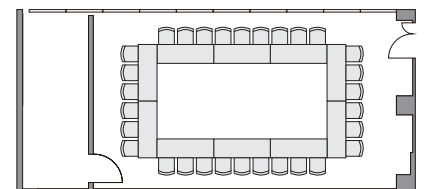

Layout Examples

Classroom style

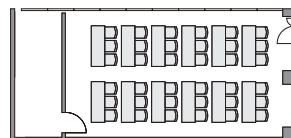

Theatre-style

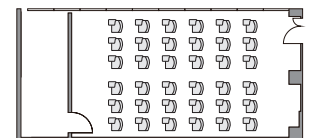

Specifications

Floor space	Ceiling height	Hollow square style	Classroom style	Theatre-style
55m ²	3m	30 seats	36 seats	36 seats
Projector	Projection on wall	Wireless microphones	Audio equipment	Roll-up curtain
○	(projection size) 120 inches aspect ratio 16:9	2	○	○

Conference Room Mercury, Mars, Venus

Movable partition walls in conference rooms Mercury, Mars, and Venus can be put away, enabling the rooms to be used as a single large conference room of 195 m².

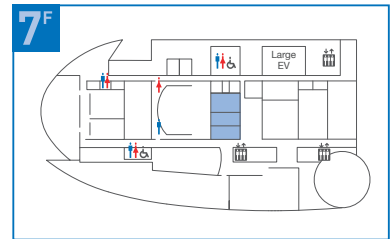

Basic layouts (Hollow square and theater style)



Floor plan / Basic layout plan

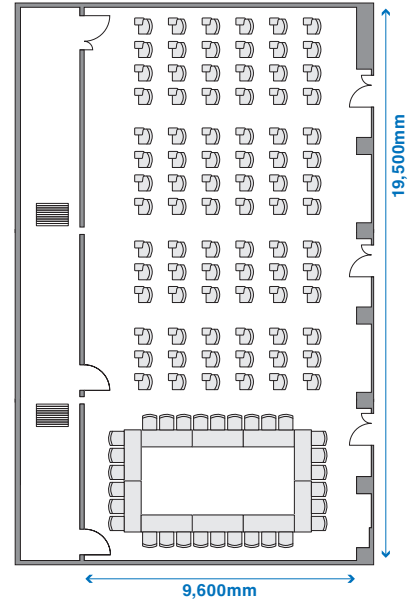

Layout Examples

Classroom style

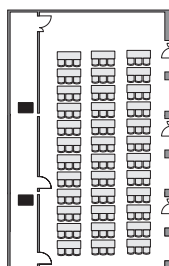

Theatre-style

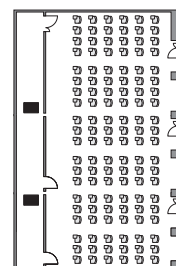

Specifications

Floor space	Ceiling height	Hollow square and theatre style	Classroom style	Theatre-style
195m ²	3m	114 seats	108 seats	120 seats
Projector	3-Sided Projection on wall (each projection size) 120 inches aspect ratio 16:9	Wireless microphones	Audio equipment	Roll-up curtain
3		6	○	○

* The projection wall can be changed in the Venus room.

Lobby(1)



Floor plan

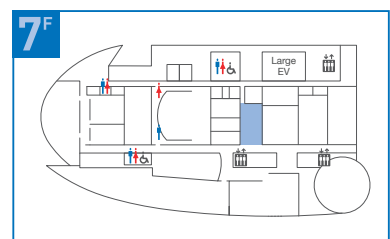
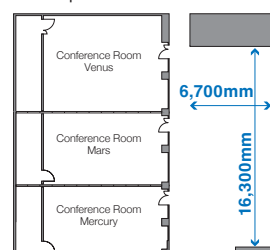

* The lobby (1) can be used exclusively for a fee when the Mercury, Mars and Venus conference rooms are rented simultaneously.(See*List of Facility Usage Fees*, P24)