

Miraikan Hall

This multipurpose hall comes in a stepped audience format, equipped with simultaneous interpretation.

Main Uses

Research presentations, experimental shows, symposiums, award ceremonies, screenings, school events, press conferences

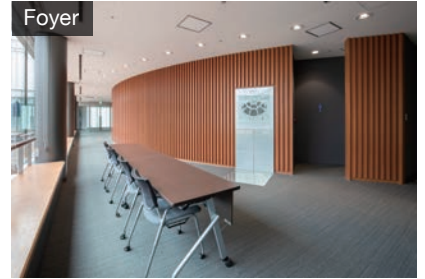
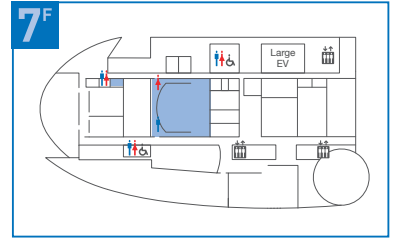

Attached Room

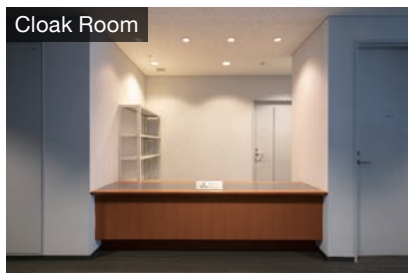

(See P14 "Waiting Rooms")

- * The attached rooms can be used free of charge.
- * A cleaning fee will be charged.(See "Cleaning, Layout Changes and Operator Fees", P25)

Floor plan

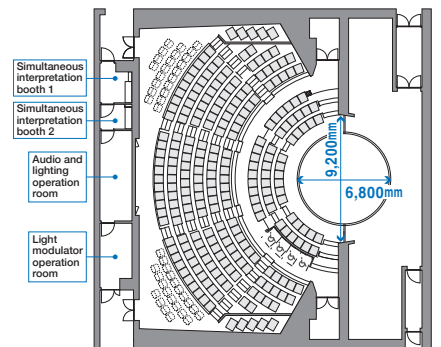

Specifications

Floor space	Ceiling height	Audience seats (fixed seats only)	Audience seats (including additional chairs + space for wheelchairs)	Projector
400m ²	7m	244 seats	292 seats	○
Screen (projection size)	Liquid-crystal display	confidence monitor (movable)	Wireless microphones	Wired microphones
230 inches aspect ratio 16:9	2 set (52 inches)	31.5 inches×1, 32 inches×2	6	6
Audio equipment	Fly system	Simultaneous interpretation booth	Attached room	
○	4 Batten	2 booths with 2 channels	Waiting Room: Moon and Cloak Room	

* Dining is prohibited in the room.
 * An operator charge applies for the use of Miraikan Hall. (See "Cleaning, Layout Changes and Operator Fees", P25)