

Conference Room Mars

A bright space designed in white base tones. Fully equipped with a projector that can project on the wall at 120 inches, this room is suitable for a wide range of uses including seminars, conferences, and presentations.

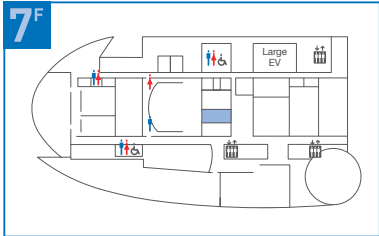

Basic layout (Theater-style)



Floor plan

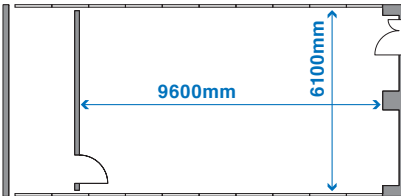

Basic layout plan

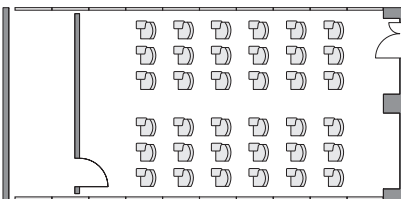

Layout Examples

Classroom style

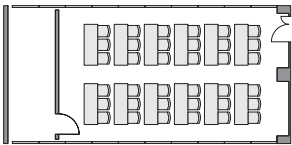

Island style

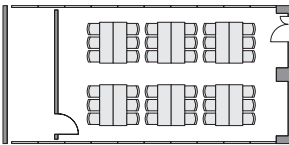

Specifications

Floor space	Ceiling height	Theatre-style	Classroom style	Island style
60㎡	3m	36 seats	36 seats	36 seats
Projector	Projection on wall	Wireless microphones	Audio equipment	Roll-up curtain
○	(projection size) 120 inches aspect ratio 16:9	2 handheld microphones and 1 pin microphone	○	○

Floor Map	List of Rental Facilities	Rental Facilities	Outdoor layout / Floor plan	List of Facility Usage Fees	List of equipment	Terms and Conditions of Use	Flow of Procedures	Other Facilities and Services	Access / Map of Odaiba
-----------	---------------------------	-------------------	-----------------------------	-----------------------------	-------------------	-----------------------------	--------------------	-------------------------------	------------------------

Conference Room Mercury, Mars, Venus

Movable partition walls in conference rooms Mercury, Mars, and Venus can be put away, enabling the rooms to be used as a single large conference room of 195 m².

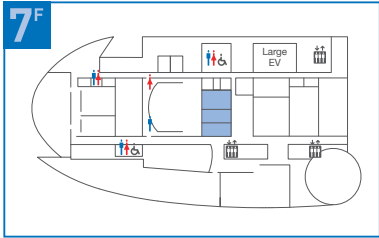

Basic layouts (Hollow square and theater style)



Floor plan / Basic layout plan

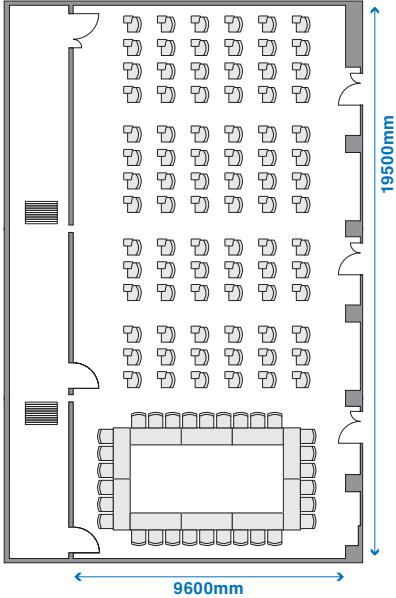

Layout Examples

Classroom style

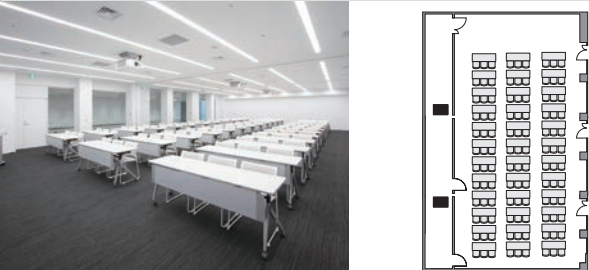

Theatre-style

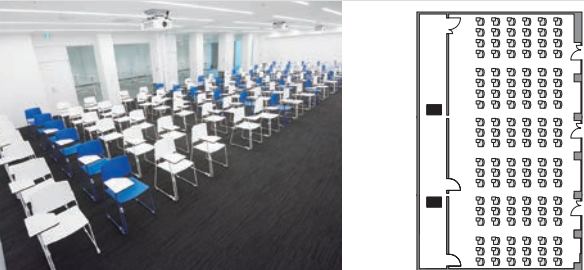

Specifications

Floor space	Ceiling height	Hollow square and theatre style	Classroom style	Theatre-style
195m ²	3m	114 seats	108 seats	120 seats
Projector	3-Sided Projection on wall	Wireless microphones	Audio equipment	Roll-up curtain
3	(each projection size) 120 inches aspect ratio 16:9	6 handheld microphones and 3 pin microphones	○	○

* The projection wall can be changed in the Venus room.

Lobby(1)



Floor plan

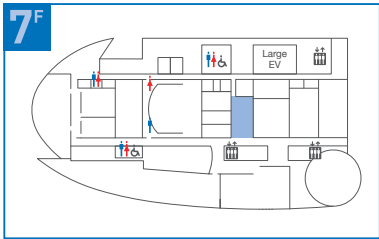
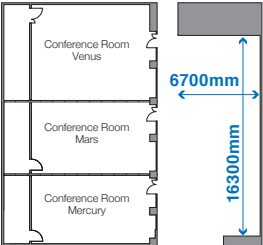

* The lobby (1) can be used exclusively for a fee when the Mercury, Mars and Venus conference rooms are rented simultaneously.(See"List of Facility Usage Fees", P24)